

X-Link Cable kit 3375

Connect an Estalky GT61 to Mimer X-Link MK2

Also refer to the X-Link setup manual.

Interface Power Supply

12VDC / max 0,3A.

Power connection through separate cable delivered with the interface. Red is positive.

Radio programming

No special programming is needed in the unit.

Connection

The unit is connected through both the microphone connector on the front and the 9-PIN connector on the back.

Volume setting

The volume of the PoC unit shall be set to ~60% volume. (The dot straight over where the keys meet)

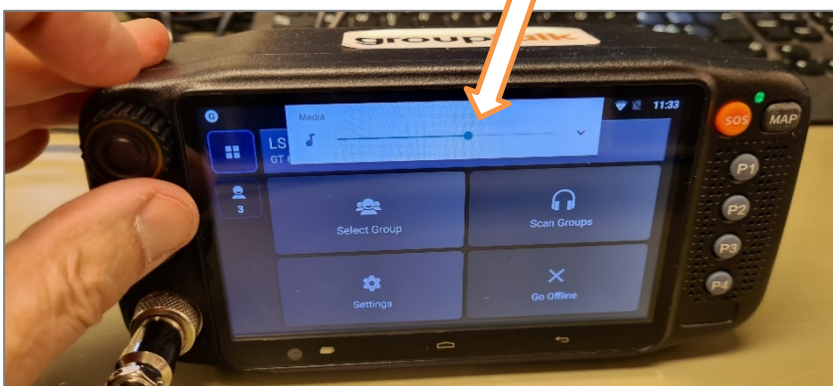

Settings in the X-Link interface

Select the proper settings for Radio A or Radio B depending on your connection.

- Radio with AF level sense for Rx detect.
- Set the detect level etc.
Details can be found in the setup manual.

The levels in the picture are our recommendations. You might find that your radio needs adjustments.

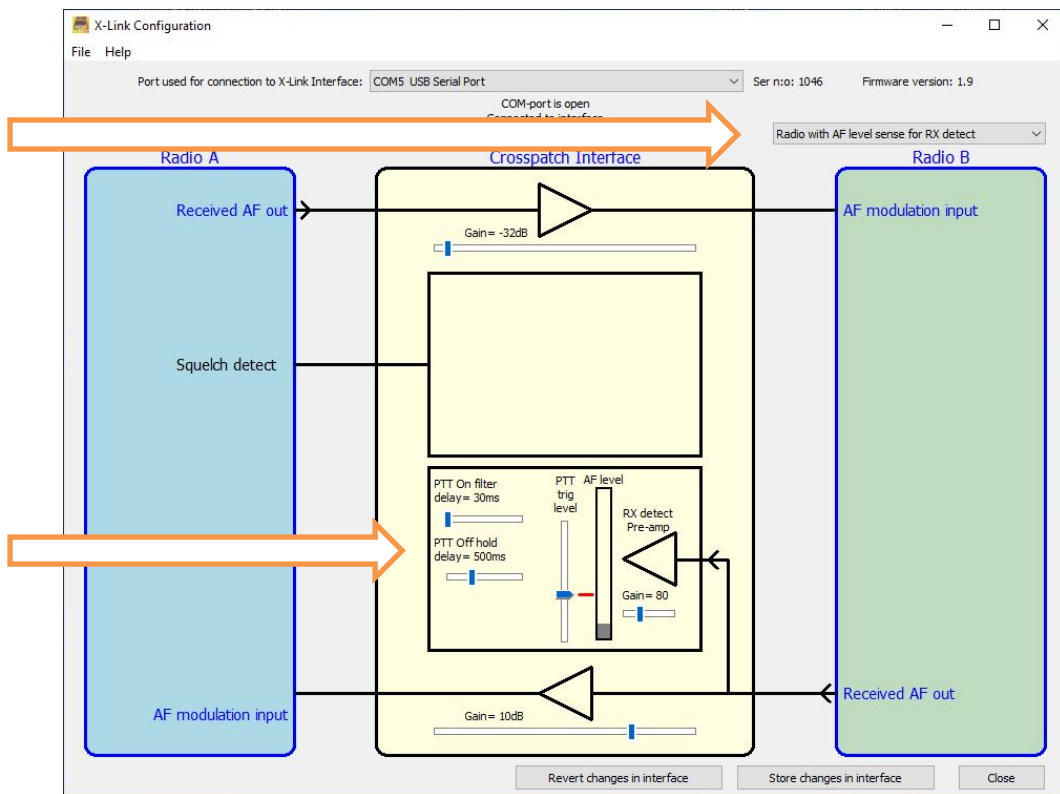

Part of the Configuration software window

Check/adjust the audio levels in both directions in the interface so that the users can hear the X-Link with the same level as when listening to other radios.

See the X-Link setup manual for details on setting the audio level.